

TRAVEL DIRECTIONS TO THE BUNDESWEHR LOGISTICS SCHOOL



Bundeswehr Logistics School
Lucius D. Clay - Kaserne
Bremerhavener Heerstraße 10
27711 OSTERHOLZ-SCHARMBECK



Central Reception and Coordination Organisation
Tel.: +49 (0)47 95 / 94 - 18302
Bw Next Generation Network (NGNBw) 23 00
Fax: 10666
Email: logsbwzentraleaufnahme@bundeswehr.org

Visitor Organisation (for day guests)
Tel: +49 (0)47 95 / 94 - 10305
Bw Next Generation Network (NGNBw) 23 00
Fax: 10666
Email: logsbws3@bundeswehr.org

- a) Railway stations: OSTERHOLZ-SCHARMBECK and BREMEN-BURG
- b) Arrival via A27 motorway: Leave the A 27 at Exit 14 (SCHWANEWEDDE) and continue in the direction of OSTERHOLZ-SCHARMBECK / BREMERHAVEN
Alternatively:
Leave the A 27 at Exit 15 (BREMEN IHLPOHL) and continue in the direction of BREMERHAVEN
- c) Navigation coordinates: Coordinates: 53.269997, 8.709126
Latitude: N53° 16' 11.9886
Longitude: E8° 42' 32.853

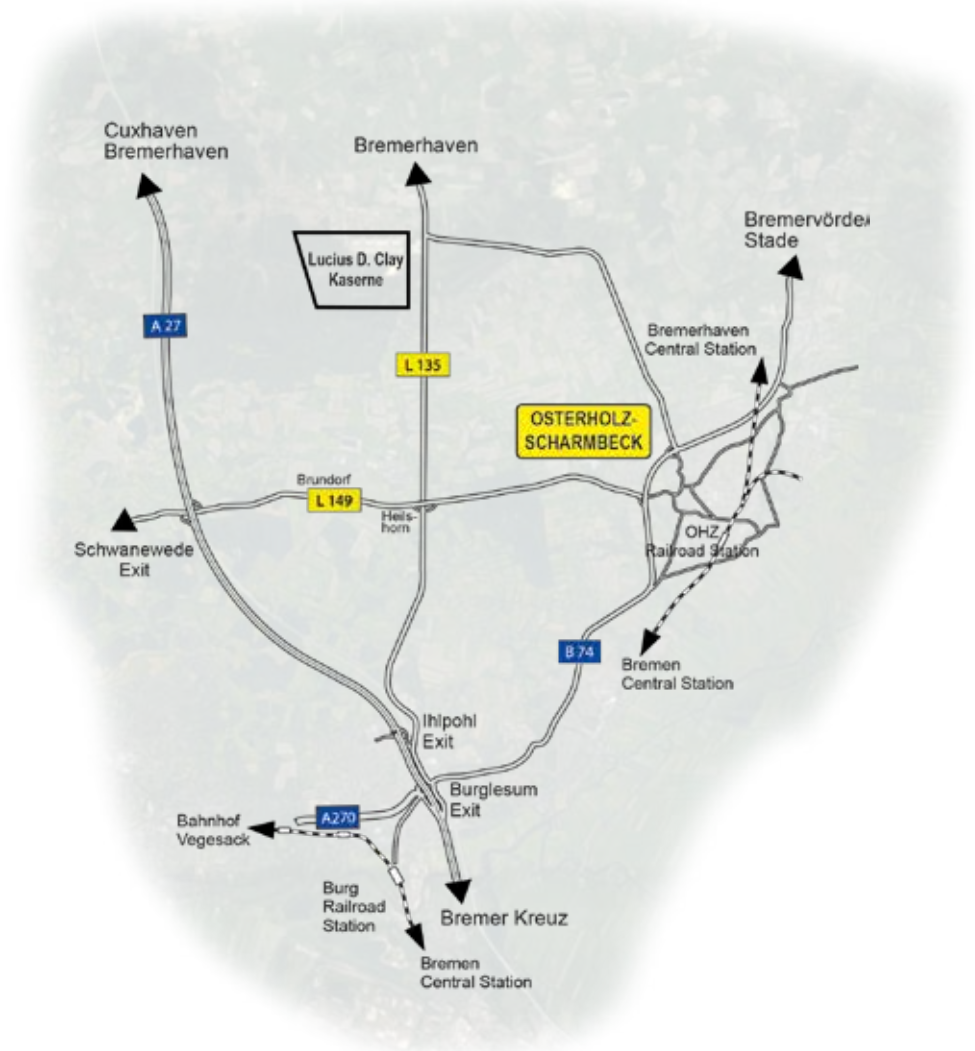

MAP OF LUCIUS D. CLAY-BARRACKS

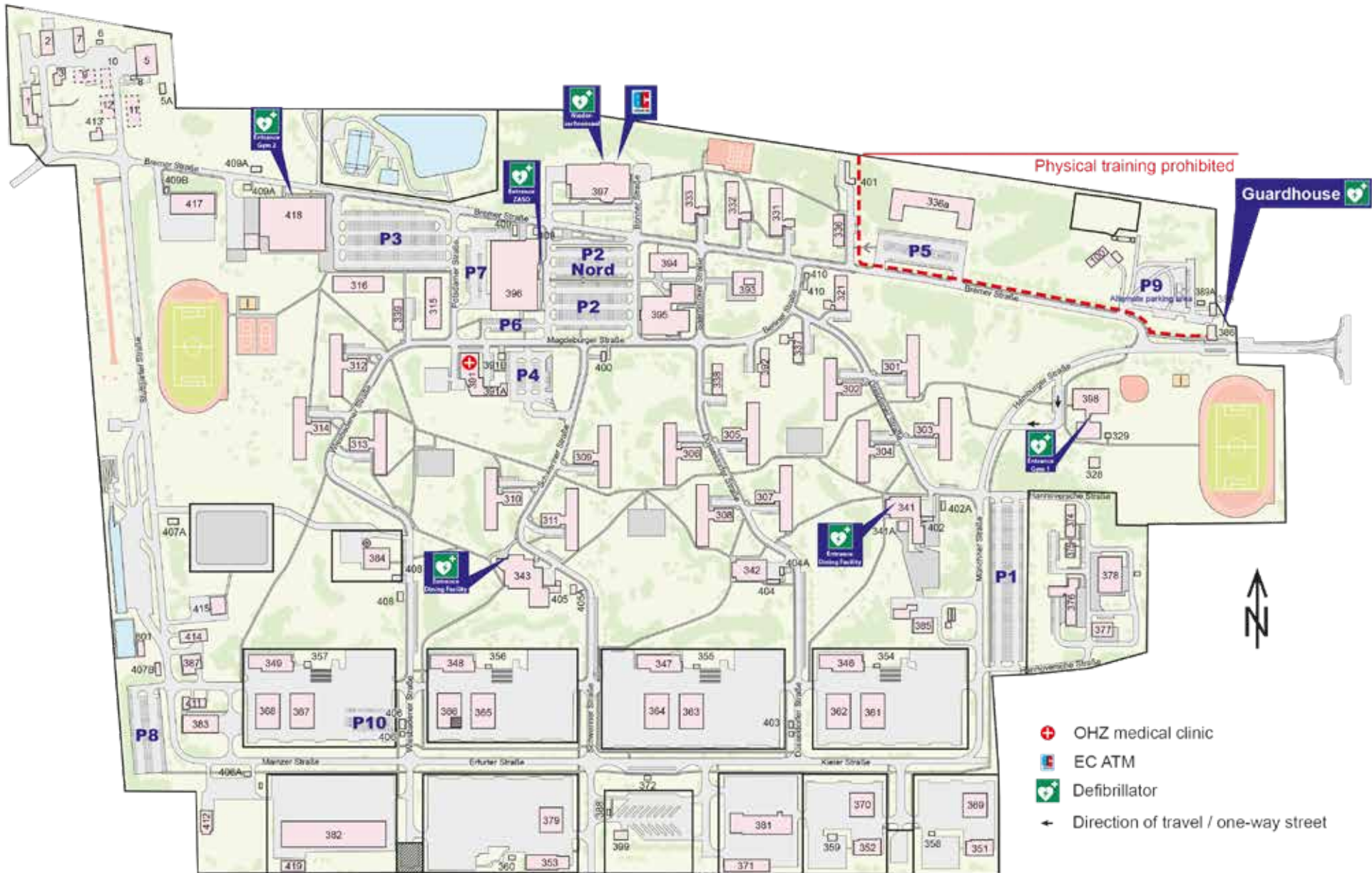

ADDITIONAL INFORMATION FOR STUDENTS ARRIVING AT WEEKENDS

Please note that in accordance with General Publication A-1900/2 „Administrative Regulation pertaining to Section 18 of the Legal Status of Military Personnel Act“, students arriving on Sundays will not be provided with government meals until the following Monday morning.

Packed lunches (dinner), which will be handed out as packed lunches to messing participants at lunchtime at weekends or on public holidays, may be ordered by contacting the dining facility's chief cook on Tel. +49 (0) 47 95 / 94 2 71 00 (Bw Tel. Netw. 90 - 23 00 - 2 71 00) -Email: TrKueGarlstedtLDC-Kaserne@bundeswehr.org by the Wednesday before arrival. Küchenmeister der Truppenküche, Tel. 0 47 95 / 94 2 71 00 (BwNetz 90 – 23 00 – 2 71 00) – E-Mail: TrKueGarlstedtLDC-Kaserne@bundeswehr.org

Opening Hours Dining Facility Building 343

	Breakfast	Lunch	Dinner
Monday - Thursday	06:15 - 08:00 hrs	11:15 - 13:00 hrs	16:30 - 18:00 hrs
Friday	06:15 - 08:00 hrs	11:30 - 12:30 hrs	Packed lunch handed out at lunchtime
Saturday, Sunday and Public Holidays	06:30 - 08:00 hrs	11:30 - 12:30 hrs	Packed lunch handed out at lunchtime

Opening Hours „Plan B Roland Club“ All Ranks Club Building 397

Monday - Thursday	08:00 - 10:00 hrs 11:00 - 13:00 hrs
	17:00 - 23:00 hrs (meals served until 21:00 hrs) If required until 24:00 hrs (at the discretion of the tenant of the all ranks club)
Friday	08:00 - 10:00 hrs
Saturday and Sunday	Closed